

## 1 BEDROOM HOME

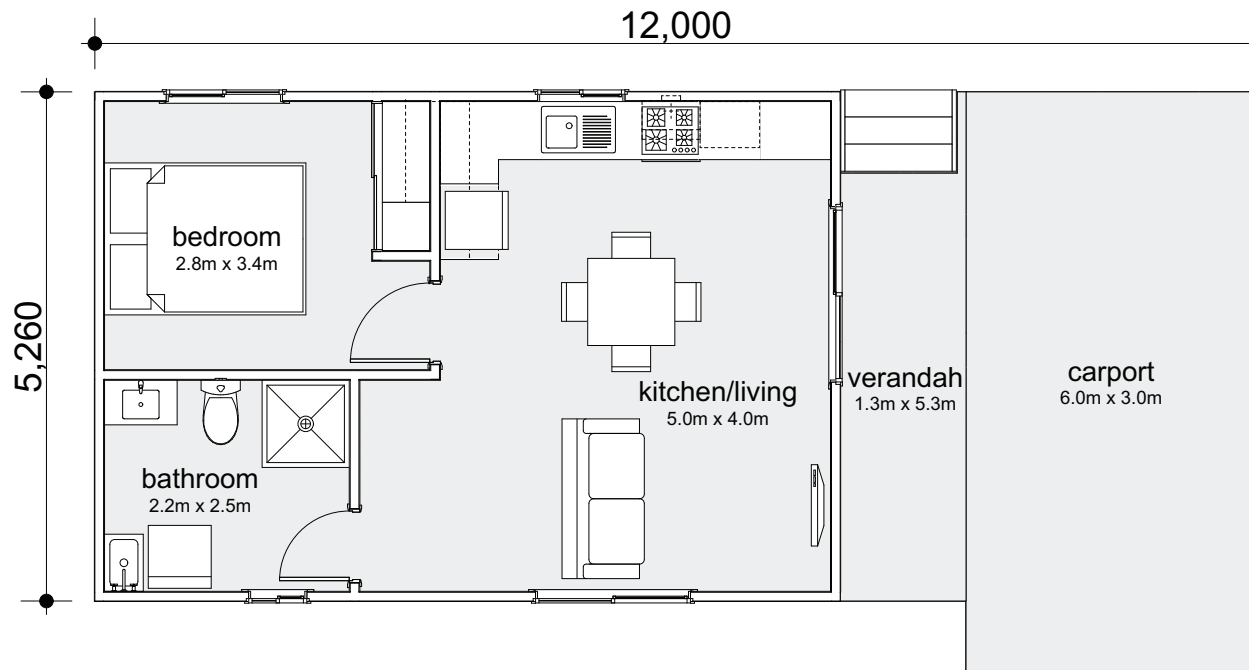

# UNIPLAN GROUP

MODULAR - THE SMARTER WAY TO BUILD

## LV1B

1 | 1 | 1

Modules:	1
Total Area:	46.8m <sup>2</sup>
Living:	20m <sup>2</sup>
Verandah:	6.8m <sup>2</sup>
Length:	9m
Width:	5.26m



### Get in touch

We would be delighted to collaborate with you and exchange ideas for your upcoming project:

T: (02) 6773 8567 E: sales@uniplangroup.co

[www.uniplangroup.com.au](http://www.uniplangroup.com.au)