

## 2 BEDROOM CABIN

## TC2L

2  | 1  | 1 

This top-selling cabin, designed for longer stays, sleeps up to six people and features a family-friendly bathroom with a separate water closet.

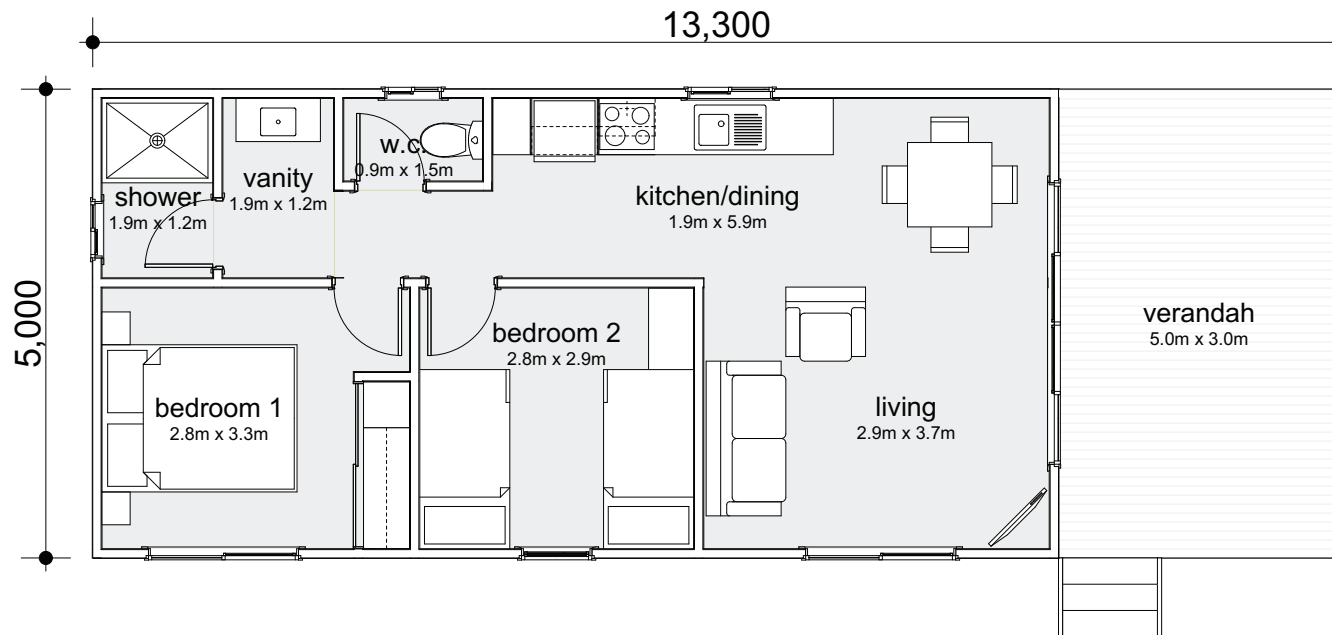

### Cabin Area

Modules:	1
Total Area:	66.5m <sup>2</sup>
Living:	10.73m <sup>2</sup>
Verandah:	15m <sup>2</sup>
Length:	13.3m
Width:	5.0m



### Get in touch

We would be delighted to collaborate with you and exchange ideas for your upcoming project:

T: (02) 6773 8567 E: sales@uniplangroup.co

[www.uniplangroup.com.au](http://www.uniplangroup.com.au)