

# Castledoyle



This modern and stylish home features a sleek one-bedroom design with study. A versatile layout and contemporary living space make it an excellent choice for a teenager retreat or student accommodation.

## Home Area

Floor Area:	59.7m <sup>2</sup>
Verandah Area:	12.0m <sup>2</sup>

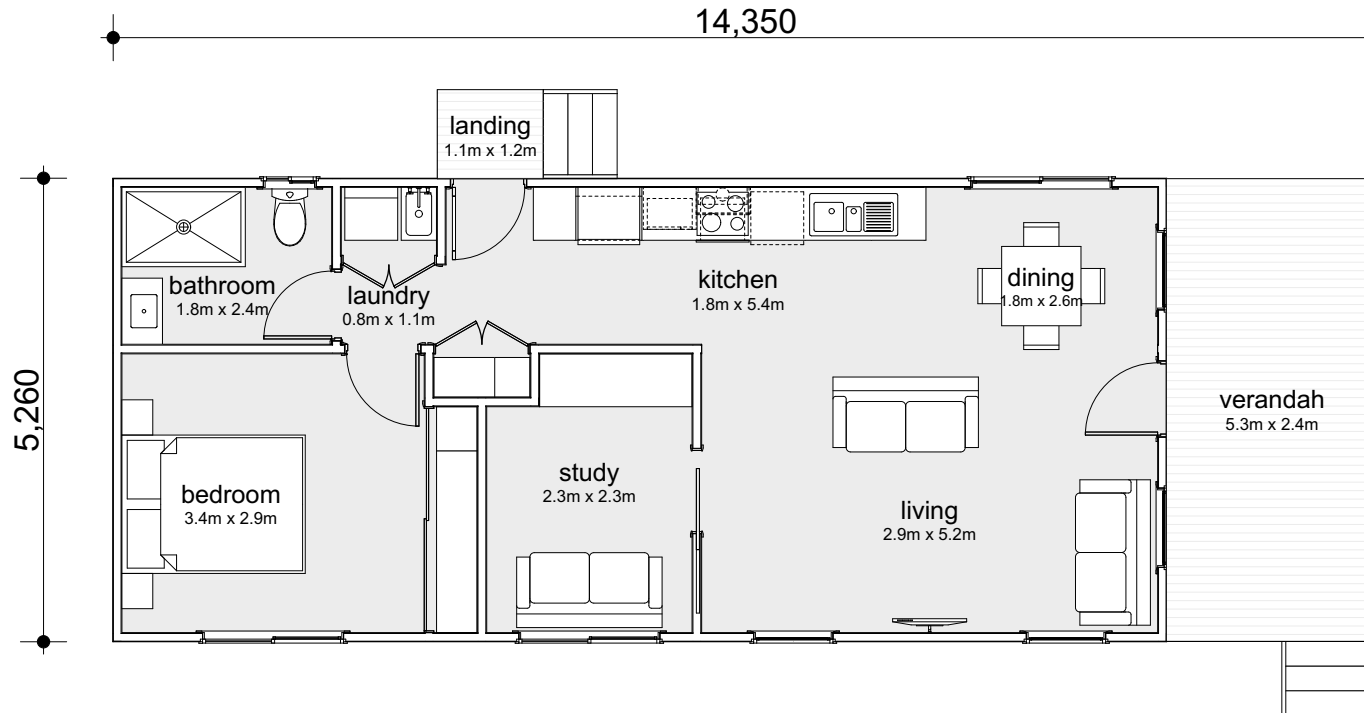

MODULAR - THE SMARTER WAY TO BUILD

## Facade Options:



## Get in touch

We would be delighted to collaborate with you and exchange ideas for your upcoming project:

T: (02) 6773 8567 E: sales@uniplangroup.co